



# POWER A SERIES

A6/A8/A8L



## Standard Features

- Hydraulic Chuck
- Gang Type Tooling
- Frequency Inverter
- Work and Alarm Light
- Foot Pedal & Safety Features
- Automatic Lubrication System
- Automatic Coolant System

## Optional Features

- Different Chucks & Collets
- Different Control Systems
- Larger Spindle
- Servo Spindle Motor
- Chip Conveyor
- Bar Feeder
- C Axis & Live Tooling

## Machine Characteristics

- German-made BOSCH Rexroth Linear Guideways
- High speed with heavy torque – suitable for machining hard materials
- 60° slant bed makes for easy chip removal
- Optional floating jaws for securely holding hard, thin-walled pipe



## Specifications

	Unit	POWER A6	POWER A8	POWER A8L						
<b>Capacity</b>	Collet/Chuck size	inch	6", * 8"	8", * 10"						
	Max. swing dia. over bed	mm	Φ500	Φ500						
	Max cutting length	mm	250	250						
	Max. swing dia. over slide	mm	Φ 160	Φ 140						
<b>Spindle</b>	Spindle bore	mm	Φ48	55*Φ	Φ55	*Φ62	*Φ75	Φ55	*Φ62	*Φ75
	Max dia. of through hole	mm	Φ40	* 45 Φ	Φ45	*Φ52	*Φ65	Φ45	*Φ52	*Φ65
	Spindle nose		A2-5	*A2-5	A2-5	*A2-6	*A2-8	A2-5	*A2-6	*A2-8
	Spindle speed	rpm	3000	*1600	1600, *4000, *5000	*2000	*1600	1600, *4000, *5000	*2000	*1600
	Main motor power	kW	7.5		11			11		
<b>Axis</b>	X axis travel	mm	250		280			380		
	Z axis travel	mm	250		250			250, *300		
	X/Z rapid traverse	m/min	12/12		12/12			12/12, *20/20		
<b>Tool post</b>	Type of toolpost		Gang type		Gang type		Gang type		Gang type	
	No. of tool stations	nos	4-6		4-6		4-8		4-8	
	OD tool shank size	mm	32X32		32X32		32X32		32X32	
<b>Structure</b>	Slant bed degree		60		60		60		60	
	Guideway type		Linear Motion		Linear Motion		Linear Motion		Linear Motion	
<b>Others</b>	Power capacity	kVA	12		16		16		16	
	Overall dimension (LxWxH)	mm	2100X1600X1750		2350X1650X1780		2350X1650X2050		2350X1650X2050	
	Weight (about)	Kg	2800		3200		3500		3500	

Note: "\*" means optional.

## Z-MaT ZHEJIANG ZHENHUAN CNC MACHINE TOOL CO., LTD.

Zhejiang Headquarter and Plant:  
 Add: Mechanical & electrical industrial zone, Yuhuan,  
 Zhejiang, 317600 China  
 Phone: +86-576-87226292 Fax: +86-576-87226290  
 www.zmat.cn E-mail: info@zmat.cn

Jiangsu Accessories Plant:  
 Shandong Precision Spindle Unit Plant:  
 Hong Kong Commercial Center:  
 Taiwan R&D Center:

Nanjing Zhenhuan Machinery Co., Ltd.  
 Weihai Giessen Seiki Co., Ltd.  
 Kimway Dragon Holdings limited  
 GreaMaT Machinery Co., Ltd.

No.1 Tuqiao Industrial Zone, Jiangning District, Nanjing, Jiangsu.  
 No.39-3 Hi-tech Industrial Zone, Weihai, Shandong.  
 701A Caroline Centre, 2-38 Yun Ping Road, Hong Kong.  
 No. 955, Section 4, Wenxin Rd., Beitun District, Taichung, Taiwan.

# POWER A SERIES

A6 / A8 / A8L

- 60°** steep inclined bed, closer to operator
- 300%** double size chip tank larger than Flash SL series
- 280%** sized linear guide way slide block
- 45mm** width heavy duty linear guideway
- 40mm** ballscrew diameter

**Power A8 rough cutting parameter**

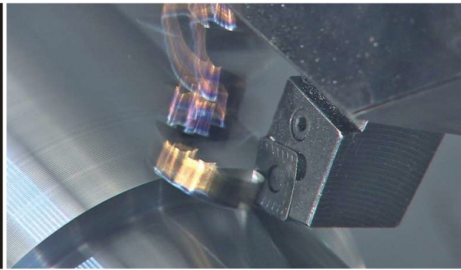

## ■ **Depth of cut**

**9mm(0.35in)**

---

Material:	S45C (Carbon steel)
Cutting speed:	220m/min(721.8 ipm)
Feedrate:	0.4mm/rev(0.016ipr)

---

When we set out to build a heavy duty cutting (hogging) machine we did a number of things:

- Increased spindle rigidity
- Widened guideway spacing
- Increased bed casting weight
- Increased spindle torque

The result is a machine that will take heavy cuts and still assure minimal tool tip vibration. Finer surface finish is the result – even when making heavy cuts.

## Greater Rigidity and Faster Speed

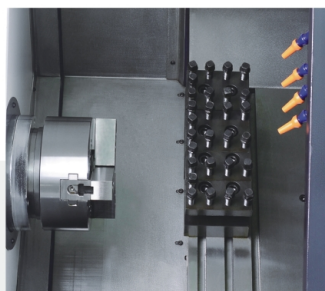

By using German-made BOSCH Rexroth heavy-duty linear guides, over-sized ball screws, thicker head stock ribs and wider bed ways we have created a highly rigid, high speed lathe. The POWER A Series is a true 60° slant bed lathe – significantly increasing machine accuracy and capacity. The steep slant bed and over-sized chip tanks allow efficient chip removal, even during “heavy cut” turning operations. An optional chip conveyor is available.

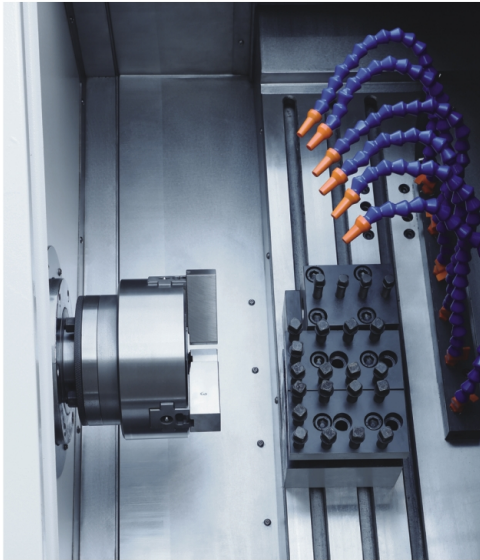

## Bearing Ring Solution

Power A machines are widely used in bearing industry. And Z-MaT has mature solutions for inner ring and outer ring machining.

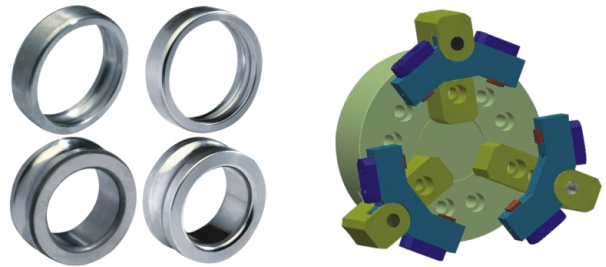

Floating jaws

### 60° (Degree) Slant Bed

Operator is close to tooling stations for easier set-ups and tool changes. Chip and coolant flow is more efficient with the steeper table incline.

### Heavy Duty Spindle

Extra built-in ribbing on the headstock and higher torque spindle drive provides a spindle ready and willing to handle all-day heavy cutting.

### Extended X Axis Travel

X Axis travel up to 380mm. Allows for a large number of gang, live tooling and turret mounted tools to be mounted on the table and sequentially moved to the point of tool tip turning contact.

### Larger Ball Screw Diameter

40mm diameter ball screw supports heavy machining operations. Pre-loaded bearings are mounted on both ends of the ball screw assembly for optimal support.

### Heavier Linear Guideways

Heavy duty ball linear guideways are necessary for heavy cutting. These heavy duty linear guides will hold up and maintain accuracy for the long-term.

### High Volume Chip Collection

Standard feature includes extra-large chip collection tank. POWER A Series chip tanks are three times larger than chip tanks used on the FLASH Series. Chip conveyor optional.

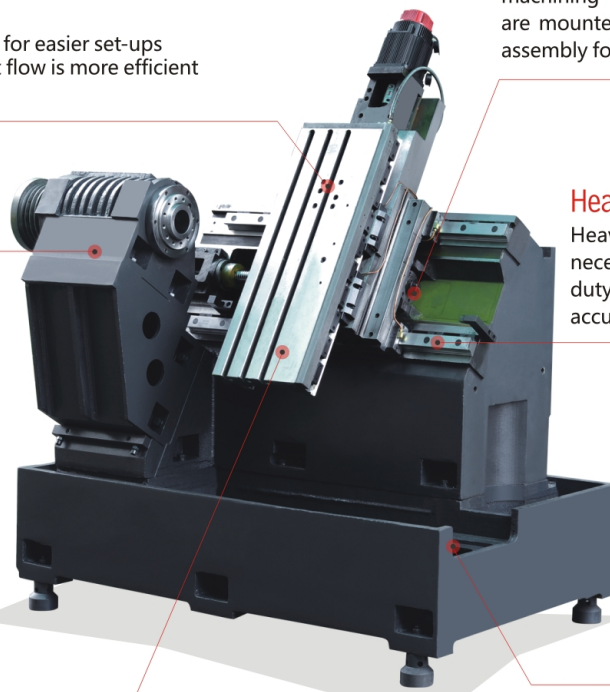

POWER A8L